

NanoLED® NXT



USAI®
Lighting

NanoLED® NXT — High Performance Pinhole

Meet USAI Lighting's NanoLED NXT, a complete 2.5" aperture LED pinhole product family. Coupled with USAI Lighting's industry-leading optical performance and perfect color consistency, NanoLED NXT is the best architectural lighting solution for quiet ceilings and a discreet appearance.

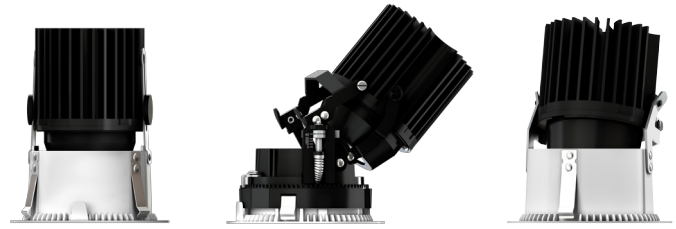

Project: Museum of the Bible
Architect: SmithGroupJJR
Photograph: Alex Fradkin Photography

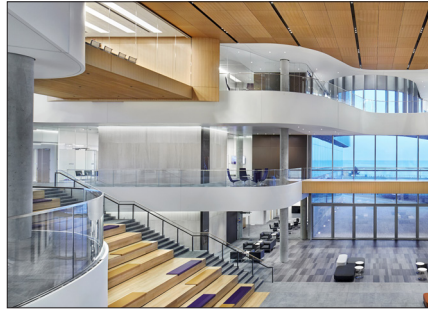

Project: Northwestern University, Kellogg School
Lighting Design: Tillotson Design Associates
Architect: KPMB Architects
Photograph: John Muggenborg



Project: Anz
Interior Design: Mancini•Duffy
Photograph: Eric Laignel

NanoLED® NXT - Superior Beam Control and Color Quality

USAI Lighting's Classic White LED color options provide best-in-class beam control and color quality. Choose from a warm 2700K, neutral 3000K, clean 3500K, or cool 4000K, and coupled with our superior color rendering means friends, furnishings and finishes always look their best. NanoLED's excellent color consistency within a 2-Step MacAdam's ellipse provides consistently beautiful light from fixture to fixture, whether downlight, adjustable, or wall wash.

Downlight



LN25RD 1/4" Regress LN10RD 1" Regress LN25SRD 1/4" Regress LN10SRD 1" Regress LN25SSD 1/4" Regress LN10SSD 1" Regress

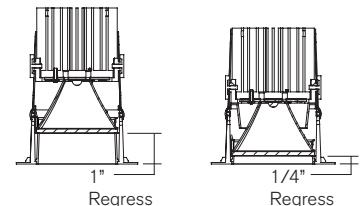

Adjustable



LN10RA 1-7/8" Regress LN10RA-W 1-7/8" Regress Wet Listed LN10SRA 1-7/8" Regress LN10SRA-W 1-7/8" Regress Wet Listed

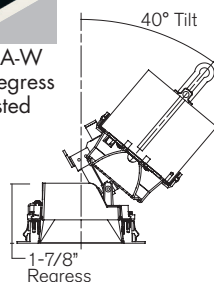
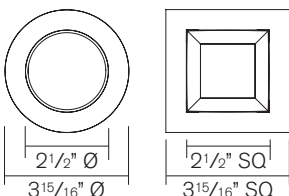

Wall Wash



LN10RW LN10SRW

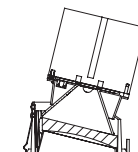

NanoLED® Cylinder

Power and beauty. USAI Lighting Cylinders put both in play, packing the benefits of our NanoLED recessed downlights into sleek and architectural cylinder fixtures available in cable or rigid stem pendants, surface mount, or wall mounted sconce styles. USAI Cylinders are perfect for spaces with open or unfinished ceilings where recessed lighting is not an option—or when designers desire a bold accent, with powerhouse capabilities.



Project: Nickelodeon Studio
Lighting Design: HLB Lighting
Architect: STUDIOS Architecture
Photograph: Bruce Damonte/Nickelodeon © 2017
Viacom International, Inc. All Rights Reserved.



Project: American Greeting Creative Studios & World Headquarters
Architect: CallisonRTKL
Photograph: © CallisonRTKL



Project: Exelon Corporation Headquarters
Architect: SmithGroupJJR
Photograph: © KCPhotography LLC.

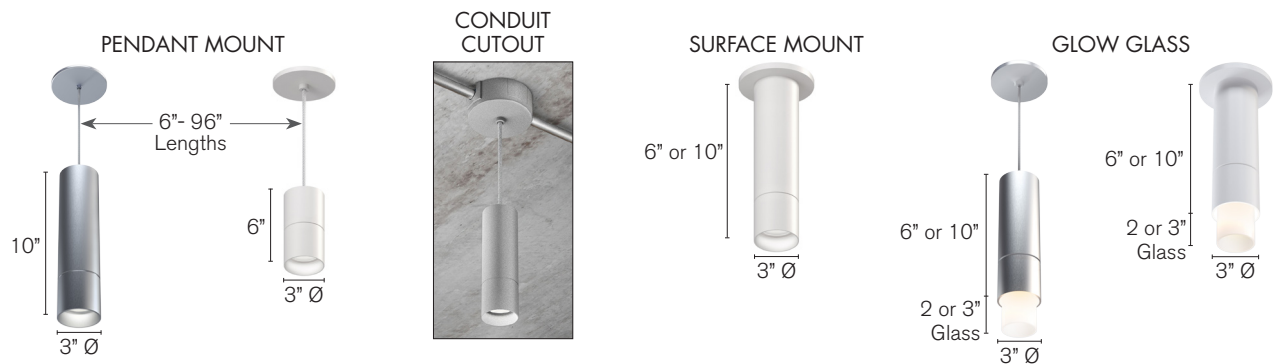

NanoLED® Glow

The classic NanoLED downlight is made decorative with NanoLED Glow. Delicate opal glass, available in round and square profiles produce a gentle ambiance that extends 1-1/2", 3", or 4" below the ceiling plane. Visually appealing and refined, NanoLED Glow is ideally suited for hospitality, fine dining, and retail - any projects where a beautiful visual element is desired with high performance lighting.



Project: Story County Medical Center
Architect: Invision Architects
Photograph: Integrated Studio, Cameron Campbell
USAI Product: NanoLED Glow

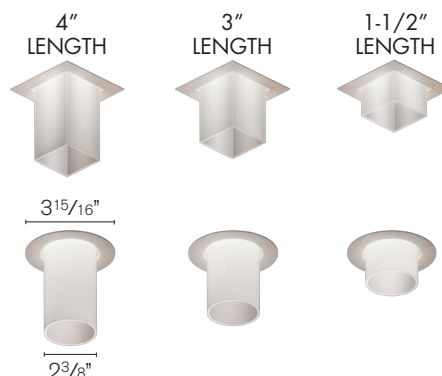



Cover photo, back page photo:
 Project: 500 Bolyston Street
 Lighting Design: HLB Lighting
 Interior Design: Studio 104
 Photographs: Bob Morris Photo

NanoLED® NXT

USAI's NanoLED offers cutting-edge performance and a 10° beam option from a pinhole aperture. Flexibility comes in the form of housing styles, trims, dimming options, beam spreads and a variety of color temperatures. NanoLED is the perfect choice for hospitality, retail, residential and commercial applications. Visit usailighting.com/nanoled for additional product information.



CALL, EMAIL, OR VISIT USAILIGHTING.COM TO LEARN MORE ABOUT NANOLED.

USAI LIGHTING COLLABORATORY
 13 CROSBY STREET
 NEW YORK, NY 10013
 (845) 234-4090
SHOWROOM@USAILIGHTING.COM

USAI LIGHTING HEADQUARTERS
 1126 RIVER ROAD
 NEW WINDSOR, NY 12553
 (845) 565-8500
INFO@USAILIGHTING.COM

©2019 USAI Lighting. All rights reserved.
 USAI, and NanoLED are registered
 trademarks of USAI, LLC.
 All designs protected by copyright.
 Covered by US Patents 8215805. Patents pending.
 CA-017E