



INTRODUCING
the LittleOnes™

USAI®
Lighting

Hello,
Tiny!



Actual Size

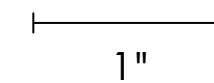

Meet the LittleOnes

Who says TINY comes at the expense of performance? USAI Lighting is defying the norm and what is possible as we raise the bar in design and engineering with a new one-inch recessed fixture family that will knock your socks off.

Two to Love

the LittleOnes™ Micro

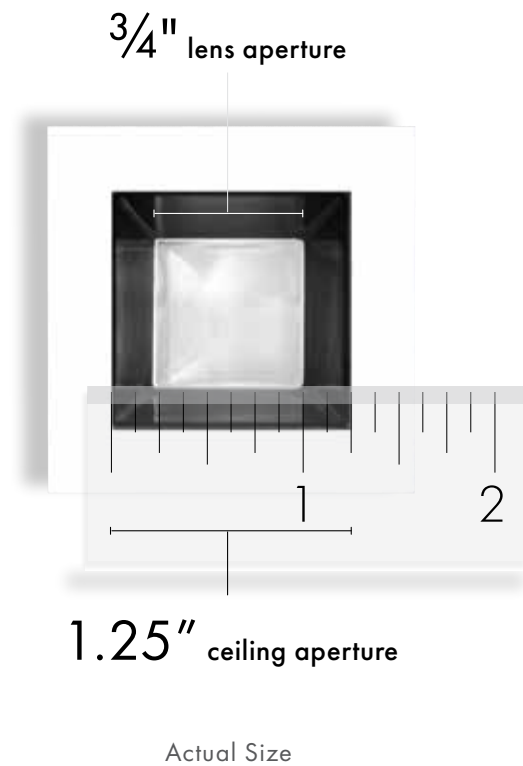

LittleOnes Micro is the USAI BeveLED family's newest tiny member. **Unique for its outstanding flexibility with a full family offering, this 1.25" dynamo provides the ultimate versatility possible** in an LED fixture this small. It's installable AND serviceable from below, and its square or round shapes can work with most typical ceiling types, including retrofit applications. Have you ever met a tiny ONE like this?

the LittleOnes™ Zepto™

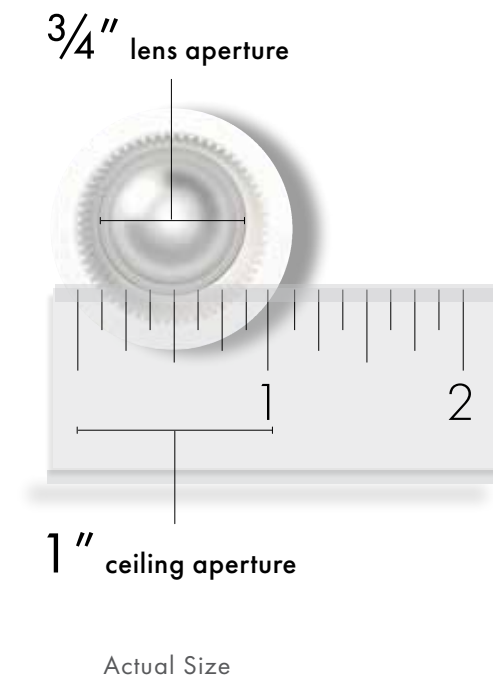

Defying what we thought possible and exceeding expectations. **Don't be fooled by its 1" size and lens aperture of 3/4"!** Yes, this guy is TINY. Like its metric system namesake, **it's teeny tiny and POWERFUL.** This little guy packs a stealth punch with over 1000 delivered lumens and literally off-the-charts glare control. Zepto provides unparalleled performance with an ultra discreet trim aesthetic.

The Power of Tiny

...Everything You Need to Light A Space

The best light sources reveal spaces, not themselves. USAI LittleOne's full lighting platform reaches new heights with a 1" aperture that's so little, it feels invisible, yet beams brilliance and creativity with high-performance.

1.25"

the LittleOnes Micro



THE POWER - From 400 to 700 Delivered Lumens

LITTLE - 1.25" Aperture

SHAPE - Round and Square

BEVELED BEAUTY - BeveLED Profile Trim Option to Match USAI's Iconic and Extensive BeveLED Family

TRIM OPTIONS - Trimmed, Trimless, Millwork

EASE - Install from Below Options, Always Serviceable from Below

HOUSING - New Construction, IC-rated, CP Rated, and Retrofit Housing Options

WATTAGE - 7W & 9W

OUTSTANDING GLARE CONTROL - UGR Less than One. Not Measurable.

BEAM SPREADS - Narrow to Wide

Classic White™ 2700K | 3000K | 3500K | 4000K

FINISH OPTIONS



Matte White



Matte Black



Specular Black

1"

the LittleOnes Zepto

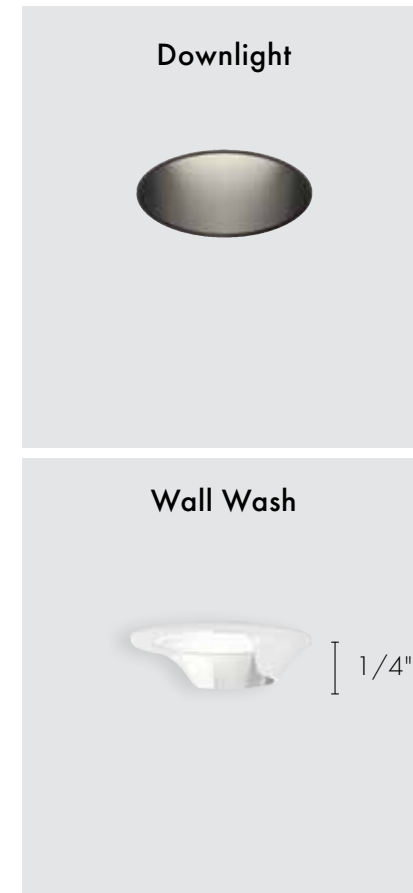

THE POWER - From 475 to 1050 Delivered Lumens

LITTLE - 1" Aperture

SHAPE - Round

DISCREET BEAUTY - Minimal Appearance

TRIM OPTIONS - Microflange and Trimless

EASE - Always Serviceable from Below

HOUSING - New Construction, IC-rated, CP Rated, and Retrofit Housing Options

WATTAGE - 7W, 9W, 11W, 15W

OUTSTANDING GLARE CONTROL - UGR Less than One. Not Measurable.

BEAM SPREADS - Narrow to Wide

Classic White™ 2700K | 3000K | 3500K | 4000K

FINISH OPTIONS



Matte White



Matte Black



Specular Black

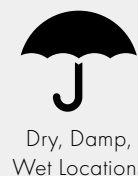
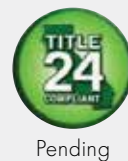

IC
Rated

CP
Rated



0.1% Dimming
Options

5 Year
Warranty

the LittleOnes
CAN LIVE
ANYWHERE
WORKS WITH ANY CEILING TYPE

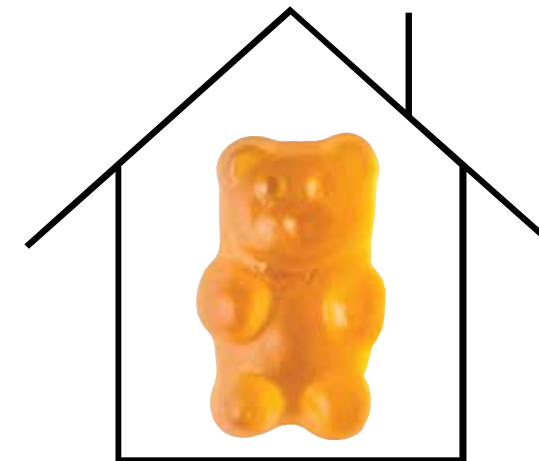



HOME | BRIGHT AND COMFORTABLE



COMMERCIAL | FLEXIBLE SPACES



HOME | INTENTIONAL INTEGRATION



HOSPITALITY | BUDGET FRIENDLY



RESTAURANTS | MILLWORK CEILINGS



SMALL SPACES | PERFECTLY PROPORTIONED

the LittleOnes

OPTICS

LIKE YOU'VE NEVER
SEEN BEFORE



Seeing is Believing

Imagine the unexpected. What would outstanding optical performance in a tiny 1" aperture look like? USAI's proprietary 5-part optical system delivers a perfect wall wash from the ceiling to the floor.



ENGINEERED FOR PERFECTION

- EXCELLENT LIGHT UNIFORMITY
- PRECISE BEAM CONTROL
- ULTRA LOW GLARE
- BEST IN CLASS BEAM QUALITY

Optics Reimagined

The LittleOnes produce an excellent wall wash distribution for evenly lit walls from floor to ceiling - with no scalloping, shadows or backlight. Performance once only available in larger fixtures now possible in a 1" aperture.

	• 14	• 14	• 14	• 14	• 14	• 14	• 14	• 14	• 14	• 14
1ft	• 20	• 20	• 20	• 20	• 20	• 20	• 20	• 20	• 20	• 20
2ft	• 27	• 27	• 27	• 27	• 27	• 27	• 27	• 27	• 27	• 27
3ft	• 24	• 24	• 24	• 24	• 24	• 24	• 24	• 24	• 24	• 24
4ft	• 18	• 20	• 18	• 20	• 18	• 20	• 18	• 20	• 18	• 20
5ft	• 14	• 14	• 14	• 14	• 14	• 14	• 14	• 14	• 14	• 14
6ft	• 9	• 11	• 9	• 11	• 9	• 11	• 9	• 11	• 9	• 11
7ft	• 8	• 8	• 8	• 8	• 8	• 8	• 8	• 8	• 8	• 8
8ft	• 6	• 6	• 6	• 6	• 6	• 6	• 6	• 6	• 6	• 6
9ft	• 6	• 6	• 6	• 6	• 6	• 6	• 6	• 6	• 6	• 6

Perfect Wall Wash Lights Smoothly from Ceiling to Floor

Footcandle measurements shown based on LittleOnes Zepto, 18" from the wall with 18" center to center spacing

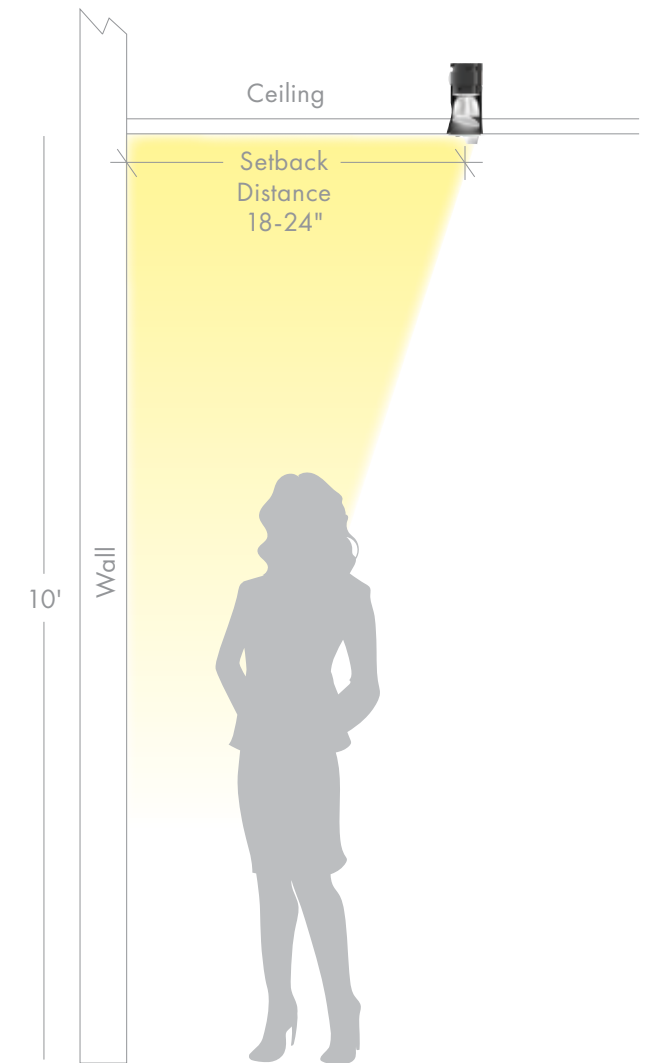

- Exceptional **4.5 : 1** Vertical Uniformity Ratio.
- USAI's patented **5-part** optical system delivers even light all the way to the ceiling line.

Quiet, Tiny and Powerful

LittleOnes Micro makes it possible to light ceilings with smaller and more efficient light fixtures.



20+ fc

Achieve 20+ fc on the floor with a 9' ceiling height and a 4' on center spacing.

0.4 Watts Per Square Foot

Incredible energy efficient performance allows for usable light while staying below local energy code limits.

the LittleOnes Micro Optics

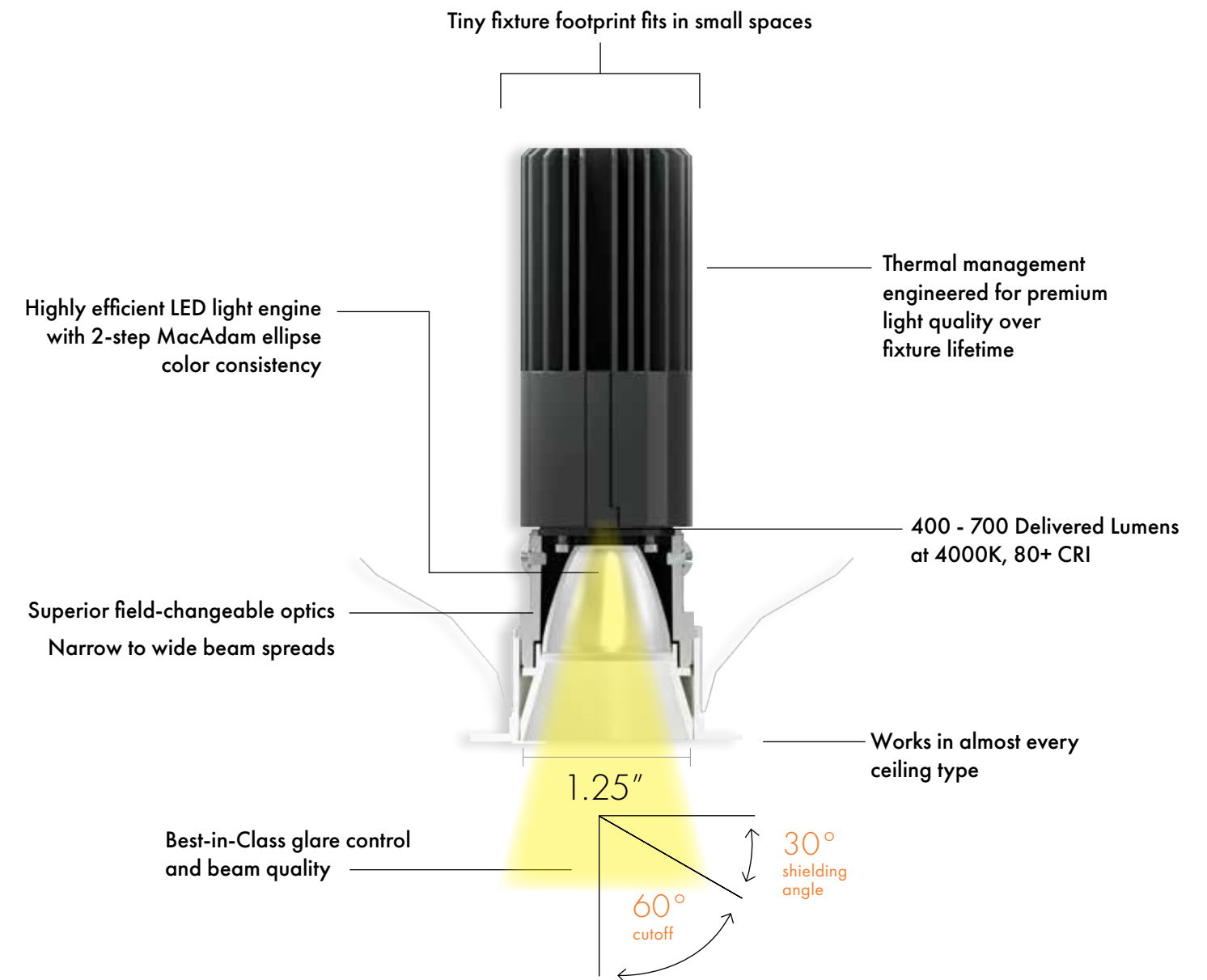

Designing for the Details with Micro

Application efficiency and light where you want it - delivered in full. These tiny points of light deliver up to 700 lumens for the perfect, comfortable illumination in any project. Hex louver trims are also available to compliment the already comfortable, precision designed, low glare optics.

Double Duty for Busy Spaces

the LittleOnes Zepto Optics

low glare
50° cutoff

Comfortable light to live, work
and play with low glare optics

50+ fc Double Duty for
Demanding Spaces

Achieve 50+ fc on the workplane with a 12' ceiling height and a 4' x 4' on center spacing.

Engineered housing for optimal thermal management, providing premium light quality over fixture lifetime

475 - 1050 Delivered Lumens
at 4000K, 80+ CRI

Highly efficient LED light engine
with 2-step MacAdam ellipse color consistency

Best-in-Class glare control,
UGR <1 (not measurable)
and beam quality

Unique twist lock
design allows
for light engine
serviceability from
below

Field-changeable
parabolic reflector
creates perfectly
soft, symmetric
beam patterns

Narrow to wide beam spreads

40°
shielding
angle

50°
cutoff

Power and Comfort Together with Zepto

the LittleOnes Zepto delivers an incredible punch from a miniscule aperture to illuminate any type of space, all while keeping ceilings quiet and comfort maximized with such amazing glare control that its glare level is not even measurable! Delivering up to 1050 lumens, this LittleOne easily provides the light you need for the most demanding of tasks and applications.

the LittleOnes
A SOLUTION
FOR EVERY INSTALLATION

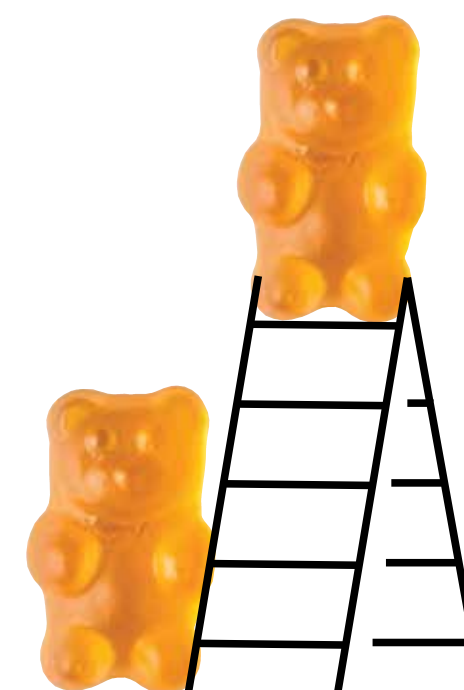

the LittleOnes Micro Install and Service from Below

During renovations and projects with existing ceilings, simplicity is key. Why remove an entire ceiling when you don't have to? With the LittleOnes Micro 1.25" flanged fixtures, installation from below is simple. A tiny, beautiful, and serviceable light fixture is only three steps away.



1 CUT
Cut ceiling opening in drywall, wood, metal, or robust acoustical material with commonly available drillbit (for round) or saw (for square)

2 CONNECT
Connect trim to remote driver with a simple quick connector

3 INSERT
Squeeze spring clips together, and push LittleOnes Micro flanged trim into ceiling opening until the flange meets the surface

Install and Service from Below.



Side View

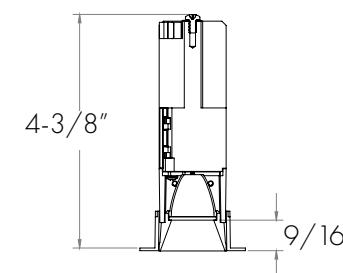

Plan View

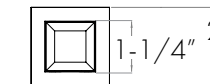

Retrofit (RT) (Flanged Only)

Retrofit (Flanged Only)

the LittleOnes Micro 1.25" can be installed in existing ceilings for retrofit applications. Simply cut a hole in existing drywall or wood ceilings to install the flanged trim.

Install from Above. Service from Below.

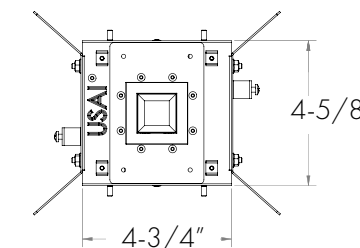
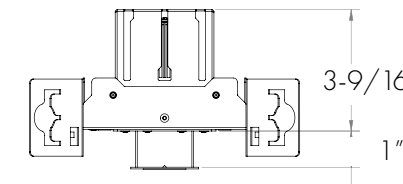

New Construction (NC) Rough-In

(required for Trimless, Millwork, and ACT ceiling installations)

New Construction Rough-In

A rough-in housing option is available for all new construction projects and a variety of ceiling types, including acoustical ceilings

Install from Above. Service from Below.

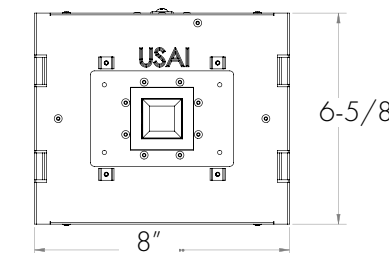
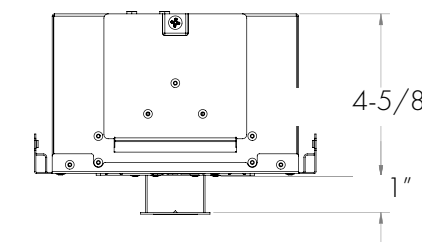
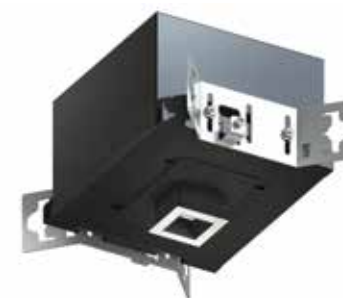

Insulation Contact (IC) Chicago Plenum (CP)*

Insulation Contact

An IC-Rated housing allows placement of the LittleOnes Micro 1.25" in direct contact with insulation, whether a flanged, trimless, or millwork aesthetic is desired.

Chicago Plenum

Our CP-rated rough-in housing satisfies Chicago's plenum requirements.

* Remote power supplies required for all LittleOnes Micro fixtures

the LittleOnes Zepto Service from Below

Zepto's proprietary, patented design makes the impossible possible – allowing LittleOnes Zepto to illuminate with 15W of sheer power AND serviceable from below through a 3/4" aperture. the LittleOnes Zepto LED light engine and optics can be accessed and swapped out from below the ceiling plane in 3 easy steps, without any mess or disruption to the ceiling.



1 PULL
Pull down on LittleOnes Zepto trim using your thumb to remove trim.

2 TWIST
Insert servicing tool to key into optics and light engine, twist counter-clockwise, then pull to remove from housing

3 SWAP
Disconnect power, and quick connection wiring. Replace light engine and optic.

Side View

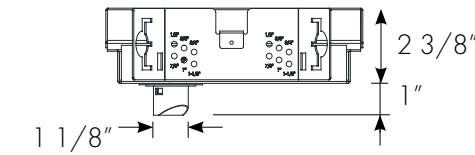

Plan View

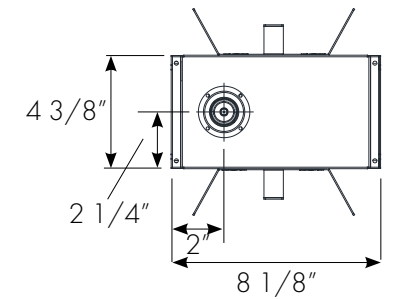

**New Construction Housing (NC REMOTE)
Insulation Contact (IC)
Chicago Plenum (CP)**

*For use with remote power supply only

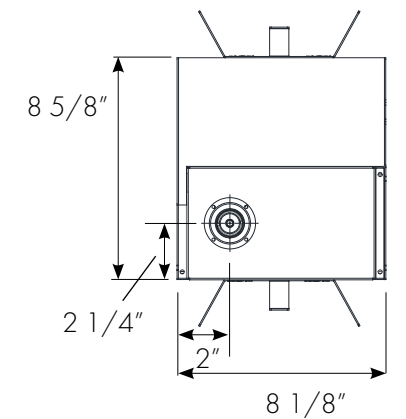
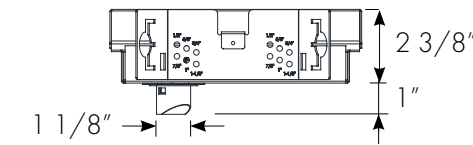

**New Construction Housing
with Integral Driver (NC INTEGRAL)***

*Above ceiling access required for all integral driver housing installations

Installation Made Easy with Remote Drivers



Place USAI's high performing Zepto downlight in a 5' x 5' on center spacing to achieve 30+ fc on the floor with a 12' high ceiling

Multiple Dimming Choices

USAI's LittleOnes are compatible with all common lighting controls; choose from 0-10V, Phase, EcoSystem, DMX, or DALI dimming

2 Ways to Work Remote

1 Light Fixture Per Remote Driver

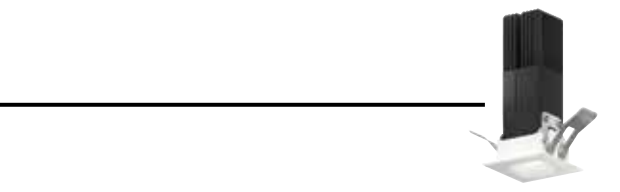

Choose a 1-to-1 remote driver for optimal performance and best possible delivered light output

2-4 Light Fixtures Per Remote Driver

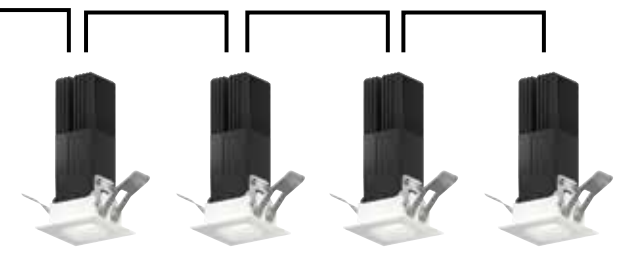

Choose a remote driver to power two or more light fixtures at a time for the most efficient power distribution solution.

*Max Distance 50-100 feet

Optional USAI Enclosures



6 Driver Prewired Enclosure
Can power up to 24 LittleOnes fixtures



12 Driver Prewired Enclosure
Can power up to 48 LittleOnes fixtures

the LittleOnes

ALL IN THE
FAMILY

CONSISTENT ROOMSIDE APPEARANCE

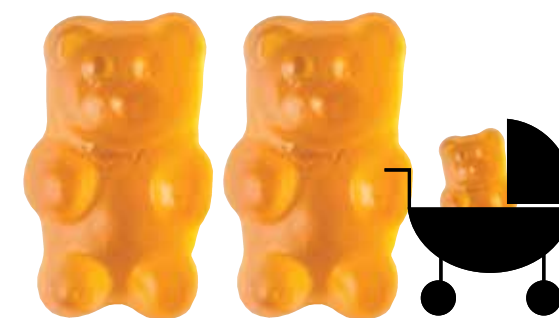

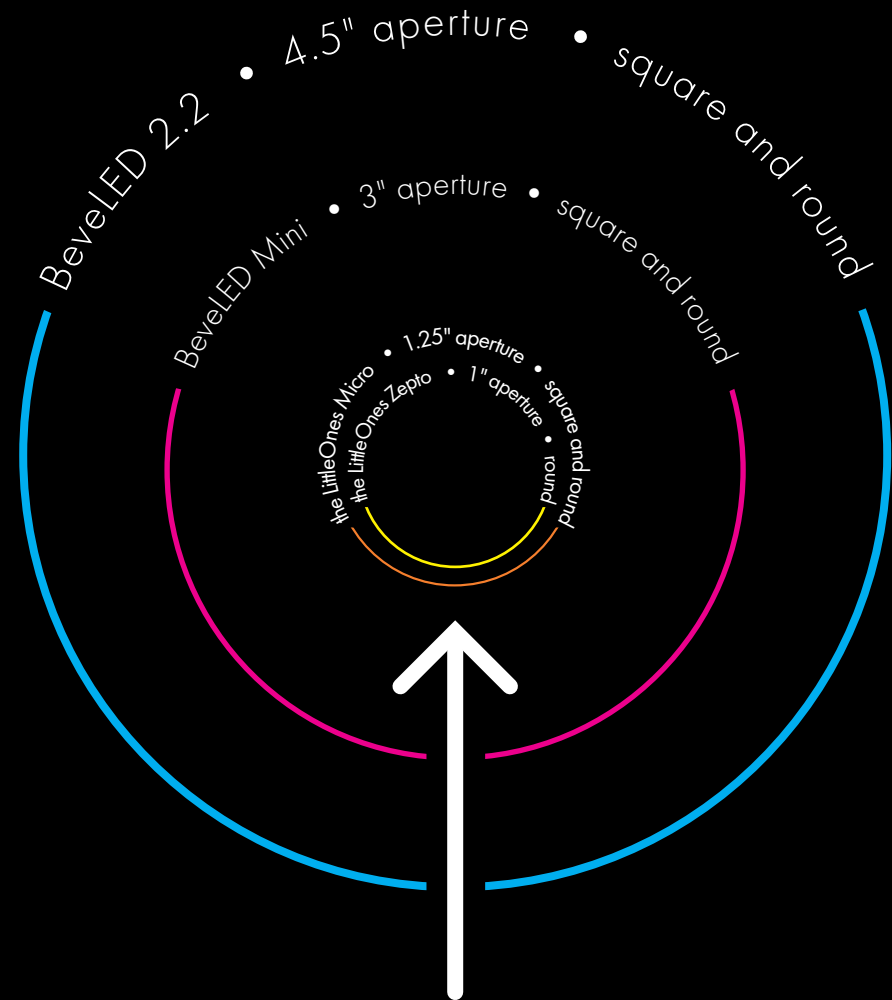

A Size for Every Space



Square + Round

Tiny Meets Small

Meet all of your LED downlight needs at USAI Lighting. Each product has its own set of capabilities with a full family of offerings. Choose from a complete platform of high-performance light fixtures to address every design requirement with the greatest flexibility from space-to-space.

1"



LittleOnes Zepto 1"



LittleOnes Micro 1.25"

3"



BeveLED Mini®

4.5"



BeveLED® 2.2

All in the Family

USAI Lighting believes in the power of innovating for small whether it's housings, recessed downlights or surface mounts and pendants. Mix and match to suit your design needs.



SHALLOW HOUSINGS



BabyLED®
3" aperture

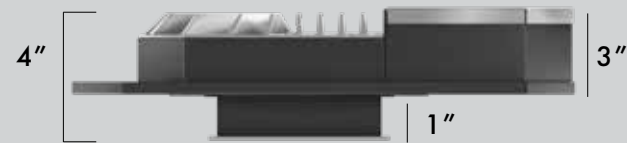

BeveLED® Flat FT
4.5" aperture

SMALL RECESSED DOWNLIGHTS



LittleOnes Zepto
1"



LittleOnes Micro
1.25"



Micro
1.25" cells



SliverLED®
1.75"

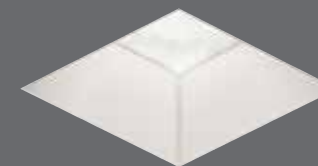

BeveLED Mini®
3"

SMALL SURFACE MOUNTED + PENDANTS

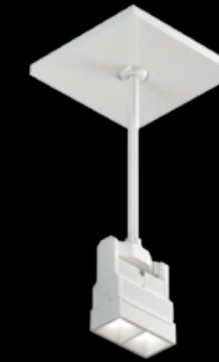

Micro Pendant
1" cells



NanoLED® Glow Cylinder
3"



NanoLED® Cylinder
3"

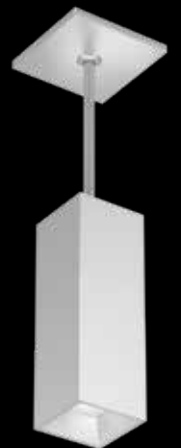

BeveLED Mini® Cylinder
3.5"

Which LittleOne is right for your space?

Lighting That Checks Every Box

	LittleOnes Micro	LittleOnes Zepto
TRIM		
Ceiling Aperture	1.25"	1"
Optical Aperture	7/8"	3/4"
Round	✓	✓
Square	✓	
Trimmed	✓	✓ Microflange
Trimless	✓	✓
Millwork	✓	
HOUSINGS		
Rough in Housing	✓	✓ Required
For Shallow Plenum	✓	✓
IC Housing	✓	✓
CP Housing	✓	✓
Wet Location	✓	✓
PHOTOMETRICS		
Source Lumens	800 - 1000lm	800 - 1475lm
Delivered Lumens*	400 - 700lm	475 - 1050lm
Wattage	7W, 9W	7W, 9W, 11W, 15W
Downlight	✓	✓
Adjustable	✓	
Wall Wash	✓	✓
Cutoff Angle (Downlight)	60°	50°
Beam Spreads Narrow to Wide	✓	✓
INSTALLATION		
Serviceable from Below	✓	✓
Install from Below	✓ Trimmed only	
Remote Drivers	✓	✓
Integral Driver Option		✓
USAI Enclosures for Remote Drivers	✓	✓

*Max Delivered Lumens at 4000K, 80+ CRI

FAQs

Q: Do the LittleOnes always require remote drivers? Where is the ideal location for remote drivers and how far away can I position them?

A: Due to the LittleOnes' miniscule size and tiny 1" apertures, it is not possible to access dimming drivers for service from below the ceiling. All of the LittleOnes are available with remote drivers which can easily be accessed in service panels or electrical closets, and they can be located up to 100 ft away depending on wire gauge used. We do have one housing option with Zepto that can house an integral driver, but this fixture would require above ceiling access to remove that driver from the housing for service.

Q: Which control systems are compatible with the LittleOnes?

A: As with all USAI Lighting products, the LittleOnes are compatible with every major architectural control system you could choose to use, including 0 - 10V low voltage dimming, line voltage phase dimming, and digital dimming protocols such as DMX, DALI, and Lutron EcoSystem.

Q: How well will the LittleOnes light my walls? How close do they need to be?

A: Despite their tiny size, the LittleOnes are outstanding in wall wash applications, providing perfect uniformity from floor to ceiling. For best results, we recommend placing them 18" from the wall and no more than 18" apart from each other.

Q: Can I place the LittleOnes in wet locations such as showers and outdoor covered spaces?

A: Yes! All of the LittleOnes are UL dry/damp/wet location rated.

Q: Can I service the LittleOnes LED and optics from below?

A: Yes! If a change is desired in LED color or optics and beam spread, you may need to access internal components. USAI's engineering has made this access easy and painless.

Q: How far apart can I space the LittleOnes and still light evenly?

A: Even though they're only 1" in size, we have found that the LittleOnes can be placed up to 4', 5', and 6' apart while still delivering useful light and great uniformity. If you're not sure, you can always contact USAI for help with applications calculations for your project.

Q: What is the maximum ceiling height recommended for the LittleOnes?

A: The answer to this question depends on how much light you need, and how closely you are placing the LittleOnes to each other. We have found that the LittleOnes can provide beautiful illumination in 8', 10', and 12' ceilings. When ceiling heights get to 14' and higher, consider using other USAI products with larger apertures and more light output; we offer a full family of companion products for the LittleOnes with similar trim aesthetics - so they look great together.

Q: How do I use the LittleOnes as emergency fixtures?

A: The LittleOnes can be specified with a remote emergency power module. Simply use the One Fixture per Driver ordering tables to specify the LittleOnes light fixture of your choice, and then specify a remote dimming driver with the EM option. All remote dimming drivers with the EM option require a remote enclosure. Two or more fixture per driver options can be used as emergency fixtures with the use of inverters. See spec sheets for details.

Q: When should I use the install from below option vs install from above?

A: The LittleOnes family is designed to be as flexible as possible for all installation types. The install from below option of the LittleOnes Micro downlight can be utilized when installing in a sheetrock ceiling that is already in place. If installing in ACT, Millwork, or for a spackled in trimless aesthetic the LittleOnes offer install from above options.

Q: In what ceiling types do the LittleOnes work?

A: The LittleOnes family works in almost every type of ceiling imaginable, including but not limited to: sheetrock, plaster, wood, tile, acoustical tiles, metal panels, and more. The LittleOnes also offers IC-rated and CP-rated housing options to meet specific construction requirements.

Let's Play

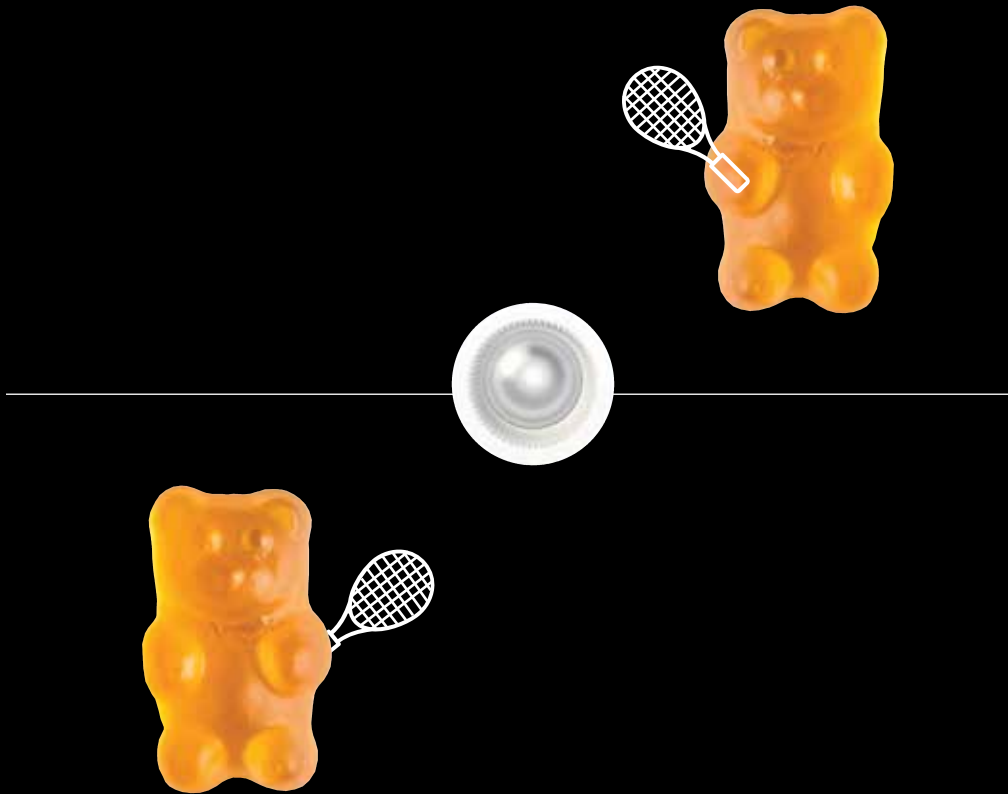

USAI[®]
Lighting

CALL, EMAIL, OR VISIT USAILIGHTING.COM TO LEARN MORE

USAI LIGHTING COLLABORATORY

13 CROSBY STREET
NEW YORK, NY 10013
(845) 234-4090
SHOWROOM@USAILIGHTING.COM

USAI LIGHTING HEADQUARTERS

1126 RIVER ROAD
NEW WINDSOR, NY 12553
(845) 565-8500
INFO@USAILIGHTING.COM

© 2021 USAI Lighting.
All rights reserved. the LittleOnes
are registered trademarks of
USAI, LLC. All designs protected
by copyright. Patents pending.
CA-103